

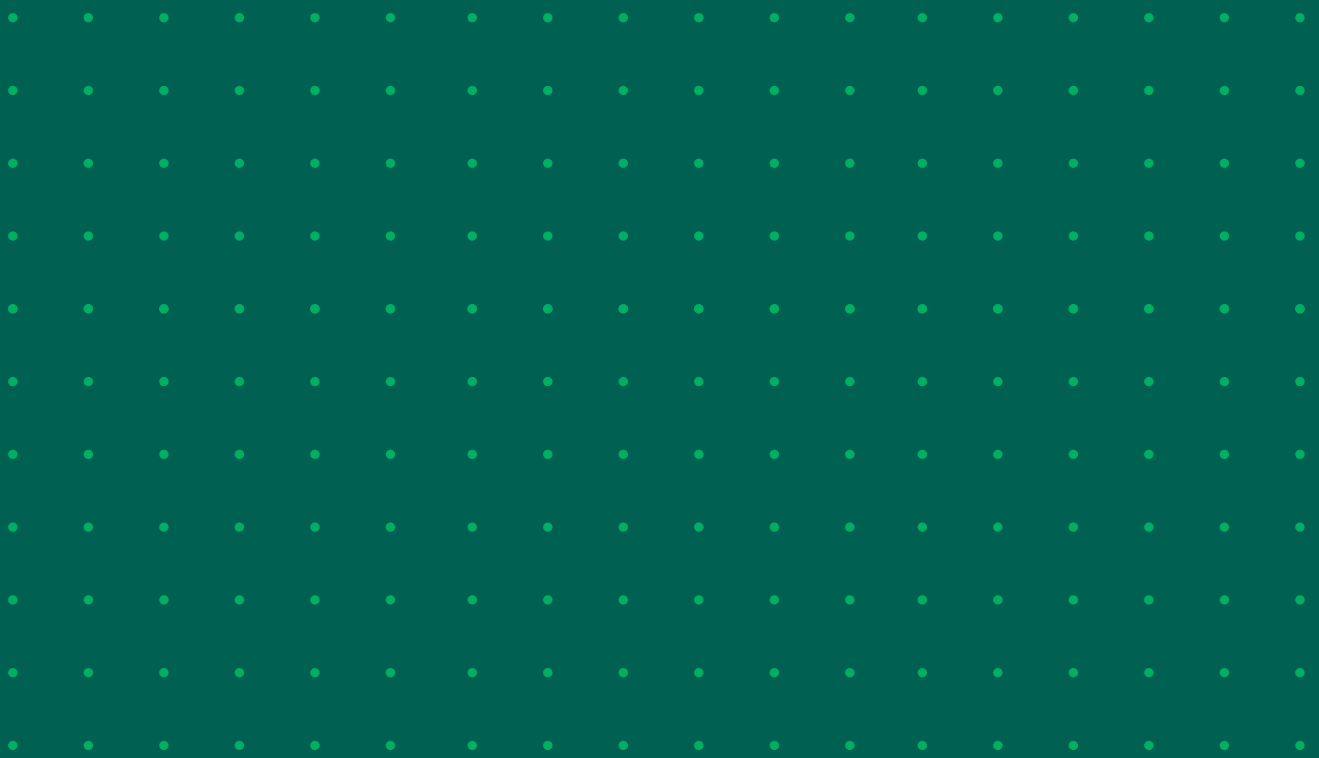

 **ZENWELD**®
Ultimate Induction Technology



ZenWeld System Description

ZenWeld Revolutionary piping system with lifetime connection guarantee.

Patented induction-welding technology for hot and cold-water systems.

ZenWeld is a pipe welding system that will change the conception of pipeconnectivity and improve pipe installation.

ZenWeld is an induction welding fitting technology, using a single welding unit, for a range of Multilayer composite pipes diameters.

ZenWeld system has a certified patents in:

- US Patent numbers 9528638, 10828840, 10710312
- EP Patent numbers 2694273

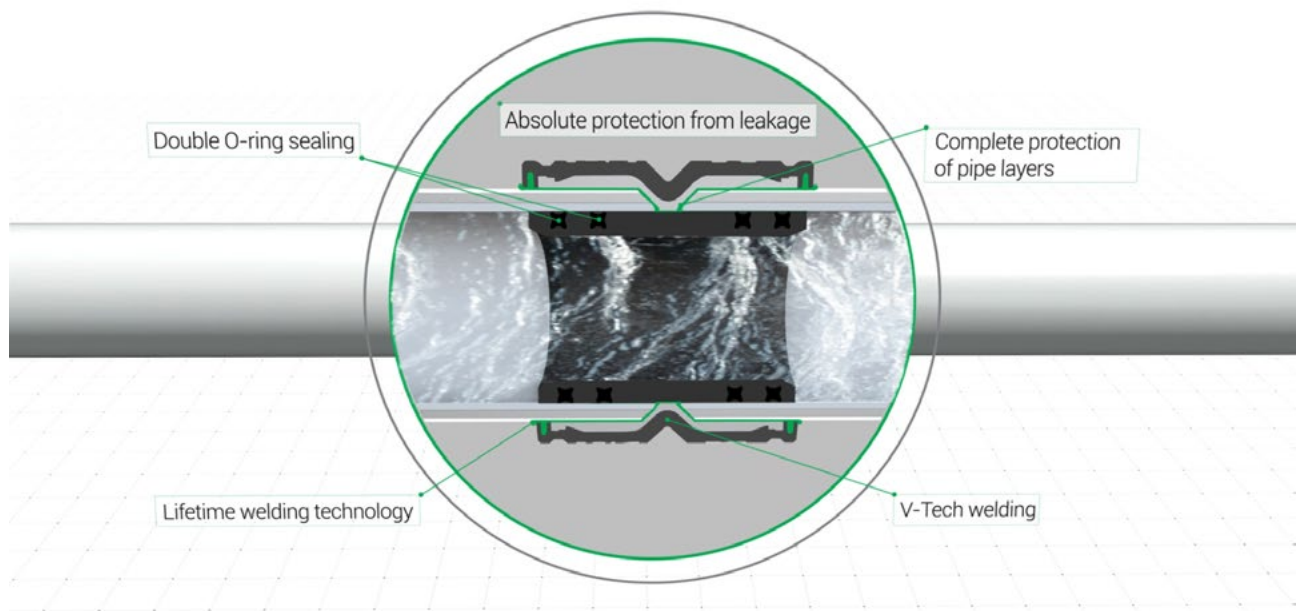

System Layout

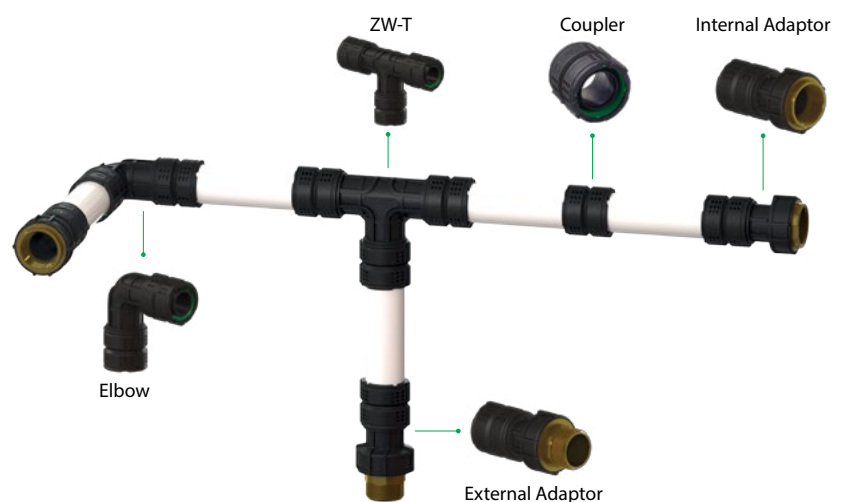
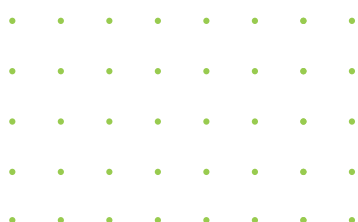

System Advantages



Quality Connection

Reliable and Ultimate connection - full proved



Installation

User-friendly intuitive installation. Lightweight system



Visual QA

Visual feedback of a successful and homogeneous welding



Self-sustained

Battery operated tool. Easy and quick welding operation



Avoid Galvanic Corrosion

Each fitting seals the pipe all over its face: inside, front, and outside



Pipe Protection

No more cuts and ruptures due to pressing, avoiding pipe fatigue



Lifetime

Polymeric welding sequence along the system protects the entire system for years



Product Approvals and Certification

System: is approved in accordance to ISO21003
Certification number: 001/007343
Materials: Thermal durability certification in accordance
Water: WRAS, NSF61, KTW
 Migration certified and approved in accordance to EN1420



Product Certification

AENOR	
AENOR Product Certificate	
Plastics	
	
001/007343	
AENOR certifies that the organization	
HELIROMA PLASTICOS, S.A.	
registered office	ZONA INDUSTRIAL EN 1/IC-2 KM 250.5 3850-184 ALBERGARIA A VELHA (Portugal)
supplies	Multilayer piping systems PERT for hot and cold water installations inside buildings
in conformity with standard UNE-EN ISO 21003	Specified in Annex to the Certificate
System description	Trademark: ZENWELD Application class / Design Pressure (bar): 1/6 ; 2/6 ; 4/6 ; 5/6 Pipes producer: HELIROMA PLASTICOS S.A. (Albergaria-a-Velha - Portugal) Fittings producer: HULIOT ACS (Israel) Type of joint: Induction welding Tipo de mordaza: N/A
	See annex for more information.
Certification scheme	In order to grant this Certificate, AENOR has tested the product and has verified the quality system implemented for its manufacture. AENOR performs these tasks periodically while the Certificate has not been cancelled, in accordance with Specific Rules RP 01.71.
First issued on	2021-12-21
Validity date	2026-12-21
	
Rafael GARCÍA MEIRO Chief Executive Officer	
AENOR INTERNACIONAL S.A.U. Génova, 6. 28004 Madrid. España Tel. 91 432 60 00.- www.aenor.com	
Product certification body accredited by ENAC, number 1/C-PR271	

Technical Datasheet

Property	Value	Test Method
System Brand Name	ZenWeld®	
Application	Hot and cold-water supply system. Fittings diameter range: 40-63 mm.	
Connection Method	ZenWeld Induction Welding	
Seal Material	EPDM Quad Ring	WARS approval number 1708564. KTW / NSF61 / UL157 Conforms to FDA standards
Application Classes	Application Class 1-2-4-5 / 6 BAR	
International Standard	Multilayer piping systems for hot and cold-water installations inside buildings	DIN EN ISO 21003
Pipe Material	PERT II / AL / PERT II 1. PE for raised temperature type II 2. Aluminium	
Pipe color	White	
Pipe size (Diameter and wall thickness)	Ø40x4,0 mm Ø50x4.5 mm Ø63x6,0 mm	
Expansion coefficient	0,025 mm/m c	VDE 0304-1-4
Tensile stress at yield	20,3 MPa	ISO 527-2
Thermal conductivity	0,4 W/m c	DIN 52612
Minimum operating temperature	-40 c	
Halogen & Cadmium Content	Free	
Fitting Material	PE-Xb -fitting body PPSU - pressure resistance sleeve Threaded fittings - approved brass thread.	Approved: NSF61 WRAS KTW listed in class A W270 microbiological growth
Fitting color	Black	
Fitting Long Term Hydrostatic Strength MRS	12.5 MPa	In accordance to ISO9080

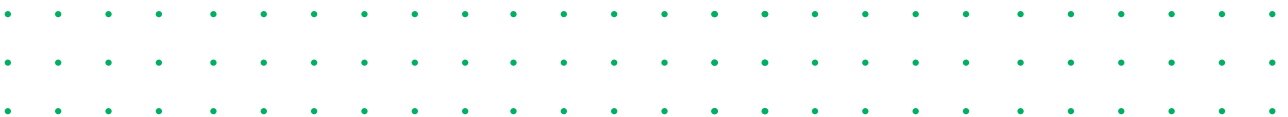

Pipe Preparation and Assembly

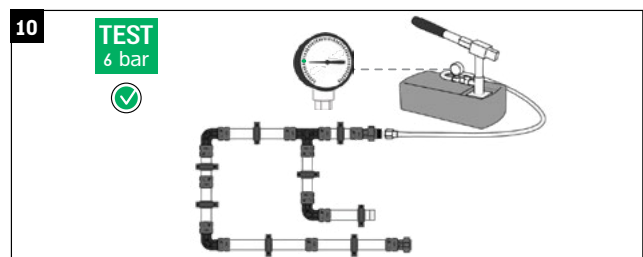
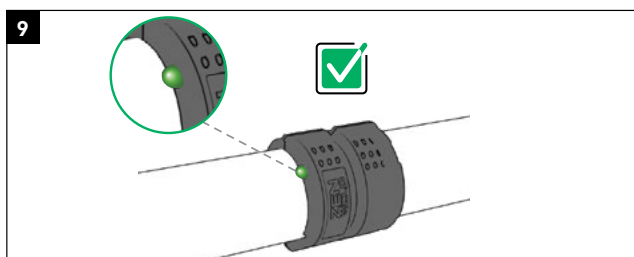
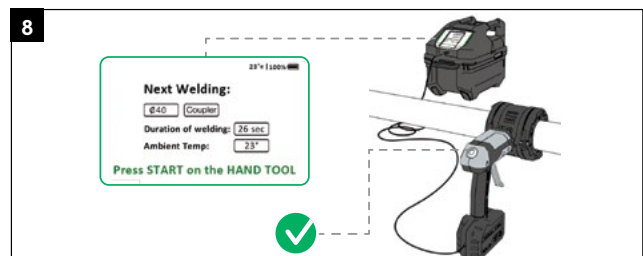
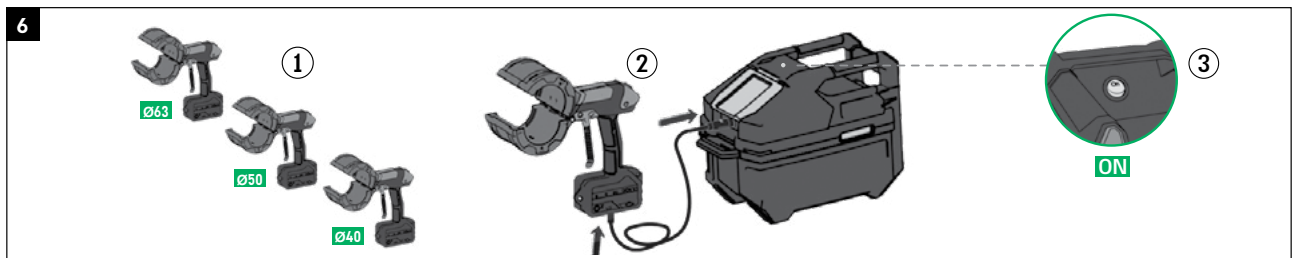
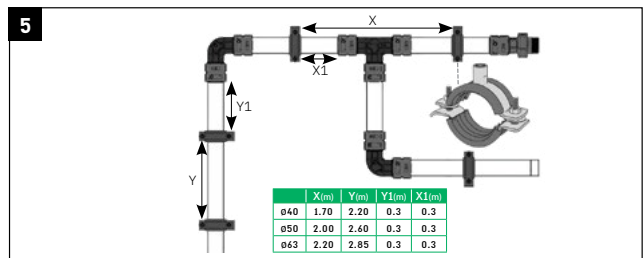
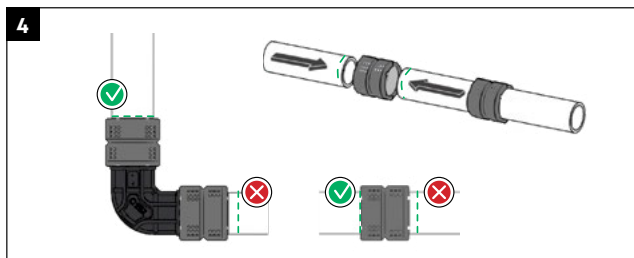
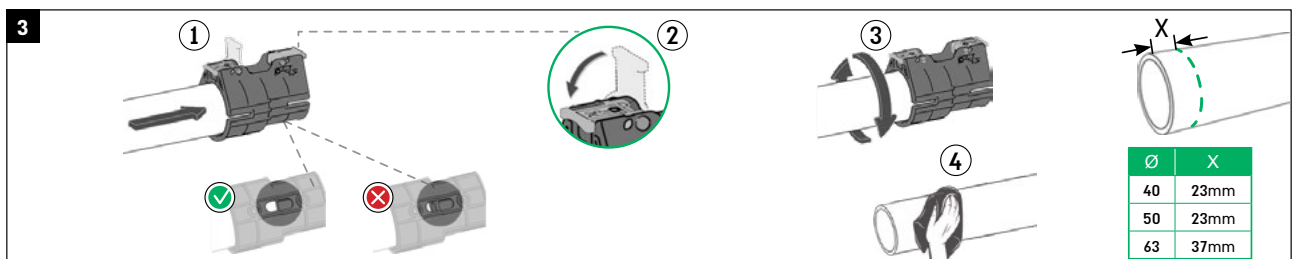
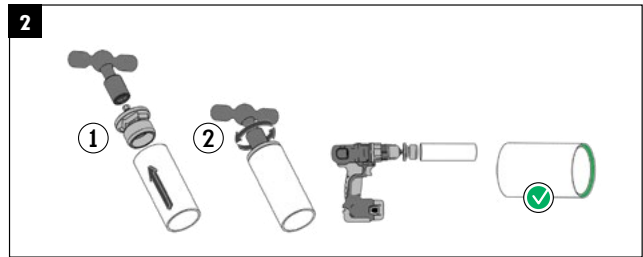
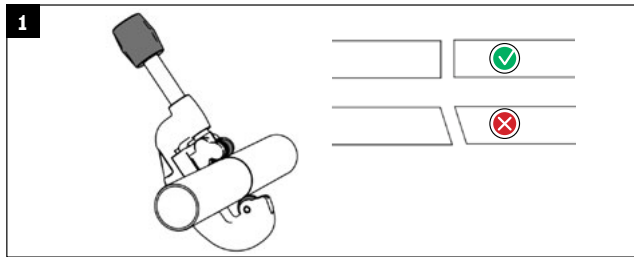

Heliklima Pipe - Multilayer

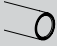
Art. No.	d	d1	S	
P-PERTAL40B	32	40	4	5/75
P-PERTAL50B	41	50	4.5	5/50
P-PERTAL63B	51	63	6	5/25

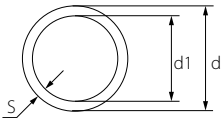

ZW-Coupler

Art. No.	Tube size	DN	B	C	D	
3042054000	40x4.0	40	57.6	23.4	20.6	40
3043055000	50x4.5	50	57.6	23.2	32.2	35
3044056000	63x6.0	63	85.5	37.4	37.0	24

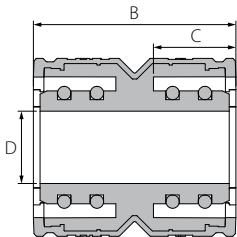

ZW-Elbow

Art. No.	Tube size	DN	B1	B2	C	d	
3042004009	40x4.0	40	141.1	141.1	23.4	20.6	15
3043005009	50x4.5	50	146.4	146.4	23.2	32.2	12
3044006009	63x6.0	63	190.7	190.7	37.4	37.0	6

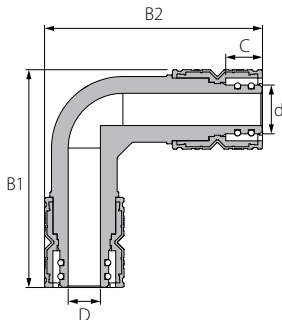

ZW-Tee

Art. No.	Tube size	DN	B1	B2	C	d	
3042104009	40x4.0	40	141.1	227.9	23.4	20.6	6
3043105009	50x4.5	50	146.4	228.2	23.2	32.2	6
3044106009	63x6.0	63	190.7	303.2	37.4	37.0	3

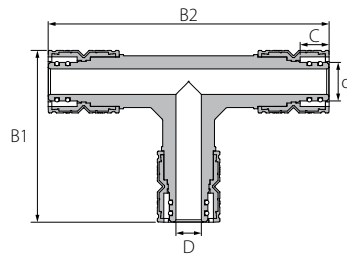

ZW-Internal Adaptor

Art. No.	Tube size	DN	B1	B2	C	D1	D2	
3042074010	40x4.0	40	118.5	67.8	23.4	20.6	BSP 1¼"	20
3043075020	50x4.5	50	128.5	73.5	23.2	32.2	BSP 1½"	15
3044076030	63x6.0	63	173.8	90.0	37.4	37.0	BSP 2"	8

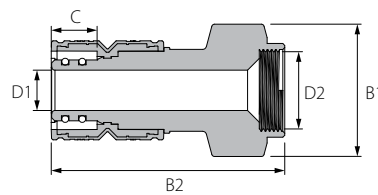

ZW-External Adaptor

Art. No.	Tube size	DN	B1	B2	C	D1	D2	
3042084010	40x4.0	40	139.4	67.8	23.4	20.6	BSP 1-1¼"	20
3043085020	50x4.5	50	153.5	73.5	23.2	32.2	BSP 1-1½"	15
3044086030	63x6.0	63	197.6	90.0	37.4	37.0	BSP 2"	8

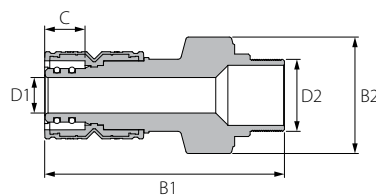

Induction Hand Tool

Art. No.	DN
3990000107	ZW-Induction Hand Tool Ø 40
3990000108	ZW-Induction Hand Tool Ø 50
3990000128	ZW-Induction Hand Tool Ø 63



Induction Power Supply

Art. No.
3990000106



Marking Tool

Art. No.	DN
3990000101	Ø40-Ø50
3990000102	Ø63



Chamfering Tool

Art. No.	Pipe size
3990000103	Ø40x4mm
3990000104	Ø50x4.5mm
3990000105	Ø63x6mm



ZenWeld BIM

BIM – Building Information Modelling – It's a revolutionary work methodology of planning, coordinate and follow-up on the multiple phases of the existence of a building. This methodology contains many advantages regarding material waste reduction and economical and time efficiency. With BIM it's possible to eliminate many construction site errors due to systems incompatibilities given that they were previously taken care of.

To apply BIM you need a tool such as Autodesk Revit®. A multidimensional platform containing one building model with all engineering and architectural components built-in. Therefore, HELIROMA is aiming towards having all main product families in Revit® for maximum productivity of its customers.

To download the REVIT ZenWeld files please scan the QR code. Notice, that the file can be read only on Revit program.





We Make it Flow.....

Huliot Group is a global leader in advanced flow systems for commercial & residential buildings, bringing complete solutions that cover water supply, wastewater, & infrastructure.

We design, manufacture & market a full range of products that work together in harmony, to deliver a seamless and silent water flow experience, while respecting the environment & keeping it clean.

.....

Huliot Group

Our story begins in 1947 in Sde Nechemiah, a young Kibbutz in the North of Israel. In their quest to build a good future for their families, our founders discovered the market potential of polymethyl-methacrylate (PMMA), a quality plastic used by the Germans, also known as Perspex®. After studying the material and its applications, they opened the doors of Israel's first plastic manufacturing plant in the Upper Galilee, between the fields and the Jordan River, where it stands to this day.

In over 75 years, we have built the company into a leading global group, growing our business both organically and through mergers and acquisitions, deepening our expertise and capturing greater parts of the value chain. Today, Huliot Group owns and operates six manufacturing plants in Israel, India, Slovenia and Portugal, and provides solutions to more than 60 markets worldwide.

Since 2019 Huliot Group is jointly owned by Kibbutz Sde Nehemia (50%) and the Tene Investment Fund (50%).



Our Mission

Like links in a chain (the literal meaning of hulirot in Hebrew), our companies work together to enhance the power of water delivery and disposal, from-and-to public infrastructures. Our mission is to create a consistent, quiet water flow for end users in their homes, at work, and in commercial and public buildings, through the delivery of reliable, state-of-the-art solutions.

Our Values



Professionalism



A passion to lead



Integrity and role model



Humility



Achieving goals together



Obligation to our community and environment

Our Products



Smart Lock™ Domestic Drainage



Ultra Silent™ Acoustic Drainage System



HT Drainage System



Manholes & Inspection Chambers



Grease & Fat Separators



Electrical & Communication

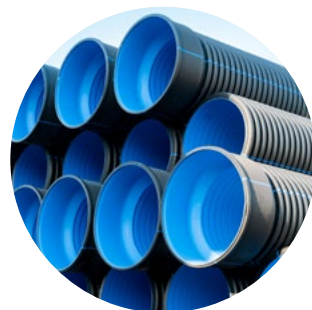

Stormwater Management

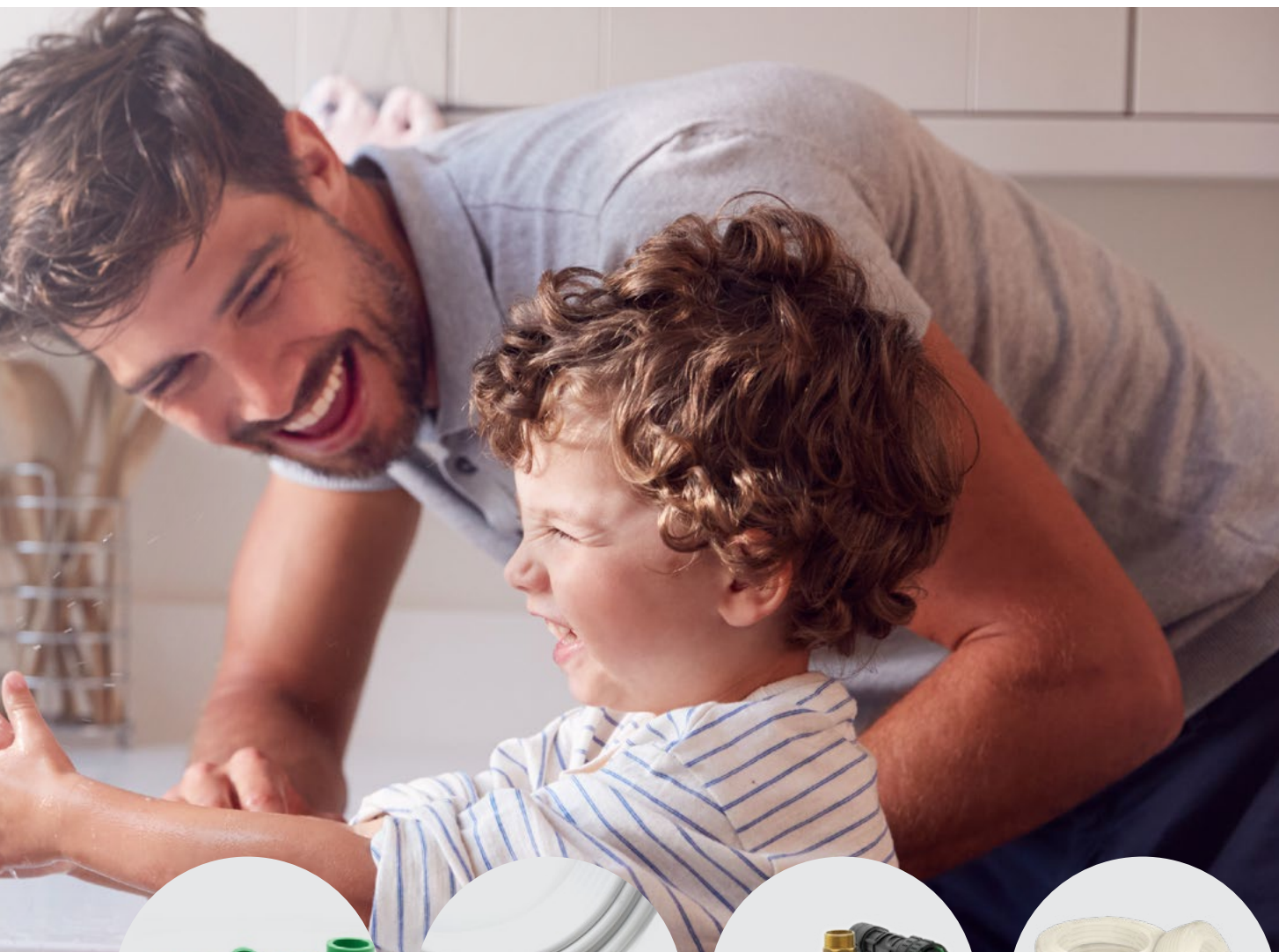

PP-R



Multilayer
System



Zen Weld™ Induction
Technology



PE-RT & PE-X



Fire Protection Net-
works



Wastewater and
Sewerage pumps



Water Supply pumps



info@huliotgroup.com | www.huliotgroup.com

 **Huliot** Group

 **Huliot** Israel

 **Huliot** Slovenia

 **Huliot** India

 **Huliot** Hofit

 **Heliroma**
by Huliot Group

 **Weisman Friedman**
by Huliot Group

 **Mahal Pumps**
by Huliot Group 

 **Huliot** Storage

 **hpg**Plastics
by Huliot Group